

**Documents corresponding to the product:**

Standard EN 62 208;  
EN 60439-1; EN 60 439-3

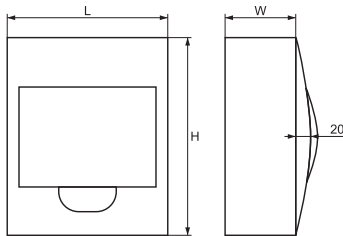

**Plastic distribution boxes for surface and flush mounting IP40**

**3** YEAR WARRANTY

The distribution boxes are designed for mounting in newly built buildings or buildings in reconstruction. They are a module box with mounted protective devices of the given flats electrical current circuit circles. They are supplied with transparent door for each row opening upwards to 90°. They are made of white self-extinguishing plastic, resistant to heat and high temperature with IP code: IP 40. The mounted device in the box is protected from direct contact to the current leading parts. They are offered with DIN-rail for device mounting and terminal strips for the neutral and earthing conductor joining. Mounted directly on the walls with screws.

**Technical data:**

- Maximum insulation voltage: 690V; 50Hz
- fire resistance rate: UL 94
- IP code: IP 40
- Class of current limiting: 2

**Boxes for surface mounting**

| Number of rows | Module capacity (number of devices) | Dimensions (mm) |     |    | Packing / Box | Catalogue number |
|----------------|-------------------------------------|-----------------|-----|----|---------------|------------------|
|                |                                     | L               | H   | W  |               |                  |
| 1              | 4                                   | 110             | 205 | 75 | 1 / 20        | <b>60040</b>     |
| 1              | 6                                   | 150             | 205 | 75 | 1 / 20        | <b>60060</b>     |
| 1              | 8                                   | 190             | 205 | 75 | 1 / 20        | <b>60080</b>     |

**Boxes for flush mounting**

| Number of rows | Module capacity (number of devices) | Dimensions (mm) |     |    | Packing / Box | Catalogue number |
|----------------|-------------------------------------|-----------------|-----|----|---------------|------------------|
|                |                                     | L               | H   | W  |               |                  |
| 1              | 4                                   | 110             | 205 | 75 | 1 / 20        | <b>60041</b>     |
| 1              | 6                                   | 150             | 205 | 75 | 1 / 20        | <b>60061</b>     |
| 1              | 8                                   | 190             | 205 | 75 | 1 / 20        | <b>60081</b>     |



## Plastic distribution boards

### Documents corresponding to the product:

Standard EN 62 208;  
EN 60439-1; EN 60 439-3



### Plastic distribution boxes for surface and flush mounting IP40

**3** YEAR WARRANTY

The distribution boxes are designed for mounting in newly built buildings or buildings in reconstruction. They are a module box with mounted protective devices of the given flats electrical current circuit circles. They are supplied with transparent door for each row opening upwards to 90°. They are made of white self-extinguishing plastic, resistant to heat and high temperature with IP code: IP 40. The mounted device in the box is protected from direct contact to the current leading parts. They are offered with DIN-rail for device mounting and terminal strips for the neutral and earthing conductor joining. Mounted directly on the walls with screws.

#### Technical data:

- Door colour: Transparent blue
- Mounting type: Surface; Flush
- Modules (N°): 12; 18; 24; 28; 36
- IP code: IP30
- Row: Single row for 12 and 18 modules
- Double rows for 24; 28 and 36 modules
- Material: ABS for body and PC for door
- Fire resistance: 650°C/30s
- Ambient temperature(°C): -5 +65°C, max. 95% humidity
- Colour: White RAL 9003
- Storage temperature(°C): -40 +75°C

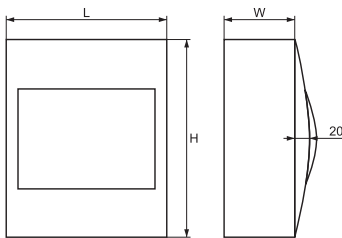

#### Boxes for surface mounting

| Number of rows | Module capacity (number of devices) | Dimensions (mm) |     |     | Packing / Box | Catalogue number |
|----------------|-------------------------------------|-----------------|-----|-----|---------------|------------------|
|                |                                     | L               | H   | W   |               |                  |
| 1              | 12                                  | 300             | 204 | 102 | 1/10          | <b>60122</b>     |
| 1              | 18                                  | 410             | 204 | 102 | 1/10          | <b>60182</b>     |
| 2              | 24                                  | 300             | 294 | 109 | 1/5           | <b>60242</b>     |
| 2              | 28                                  | 310             | 354 | 109 | 1/5           | <b>60282</b>     |
| 2              | 36                                  | 410             | 294 | 109 | 1/5           | <b>60362</b>     |

#### Boxes for flush mounting

| Number of rows | Module capacity (number of devices) | Dimensions (mm) |     |     | Packing / Box | Catalogue number |
|----------------|-------------------------------------|-----------------|-----|-----|---------------|------------------|
|                |                                     | L               | H   | W   |               |                  |
| 1              | 12                                  | 317             | 220 | 102 | 1/10          | <b>60123</b>     |
| 1              | 18                                  | 426             | 220 | 102 | 1/10          | <b>60183</b>     |
| 2              | 24                                  | 317             | 310 | 109 | 1/5           | <b>60243</b>     |
| 2              | 28                                  | 294             | 338 | 109 | 1/5           | <b>60283</b>     |
| 2              | 36                                  | 426             | 310 | 109 | 1/5           | <b>60363</b>     |

